



HDX-68C-CAC

Dakota Digital HDX Instrument Installation
For 1968 Chevrolet Camaro with Console Gauges

HDX Displays

Your new HDX-68C-CAC kit includes:



Universal Sender Pack

Buzzer

Installation Manuals



4X Fender Washers



4X Thumb Nuts



Control Box



2X Flat Spring Nuts



Y Harness



Foam Tape



(2) Main Harnesses



Interconnect Harness

Installation

1. Remove the stock gauge cluster from the dash.



2. Remove the five screws holding the gauges to the bezel on the back of the system.

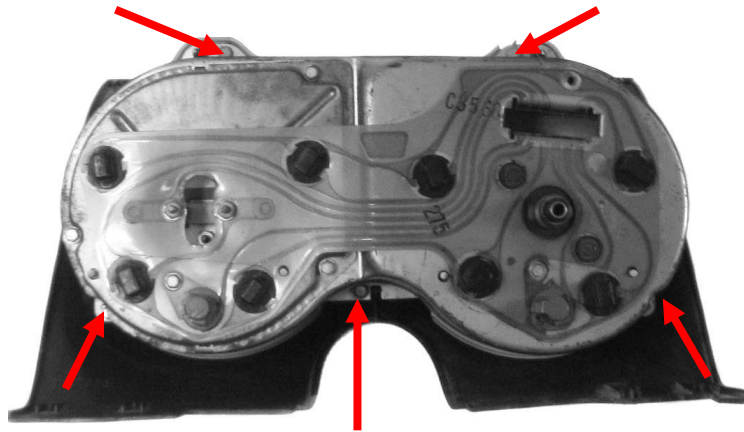

3. Remove the stock gauges and lens from the bezel



4. For this step, you can re-use the stock foam blocks or use the supplied foam to make replacements for missing or brittle foam pieces. Cut the supplied foam into four small pieces, approximately 1.5" long.



On the top two locations, fold the foam over the edges and make sure it's not sticking into the visible window. In the bottom two corners, the area for the tape is slightly narrower than the foam so you will need to ensure the foam is curved with the opening in the housing.

5. Mount the HDX system to the bezel using the five original screws from disassembly.



6. Connect the provided interconnect harness to the back of the HDX system.

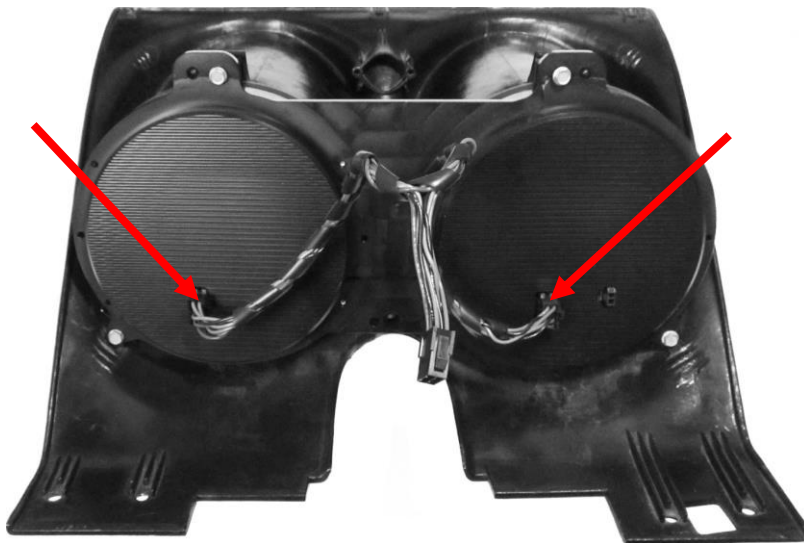

7. Connect the provided harness and the buzzer (optional for audio feedback) to the back of the HDX system.

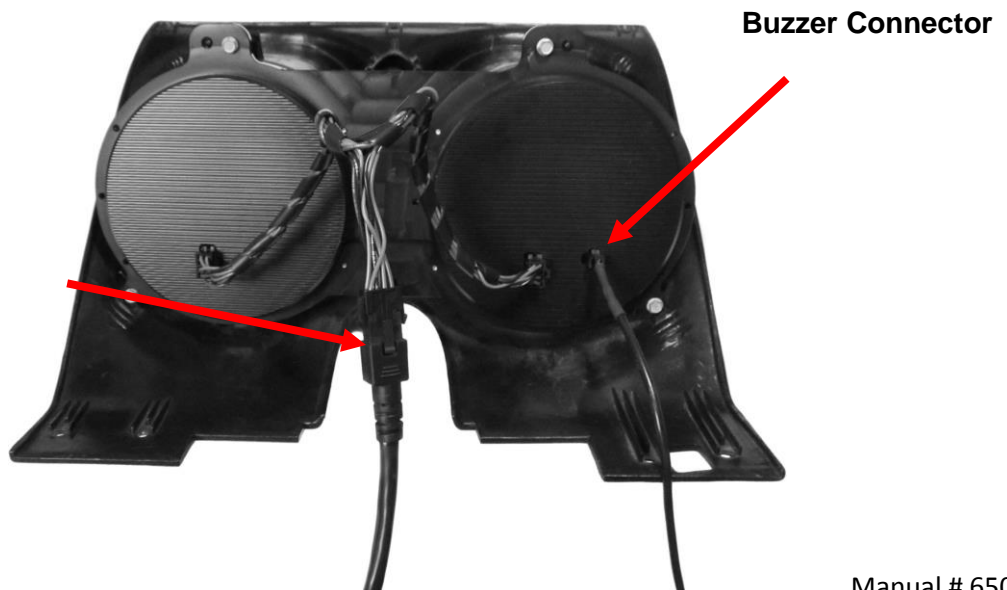

8. Re-install the Main cluster back into the car using the stock hardware.



9. Next, the entire console will need to be removed. Looking at the picture of the console from the bottom, you can see there are four (4) mounting points. Make sure to disconnect all electrical connections and save all hardware for reinstallation.

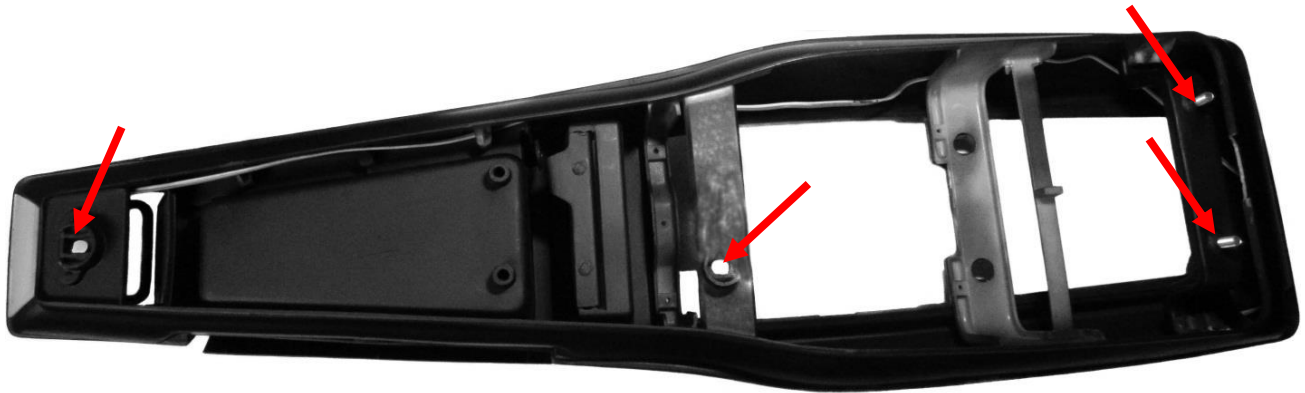

10. Remove the gauge cluster from the console by removing the four (4) screws holding the cluster to the console. Also remove the top screws that hold the bezel to the housing as shown in the picture. The bezel and screws will be reused for the new gauges.

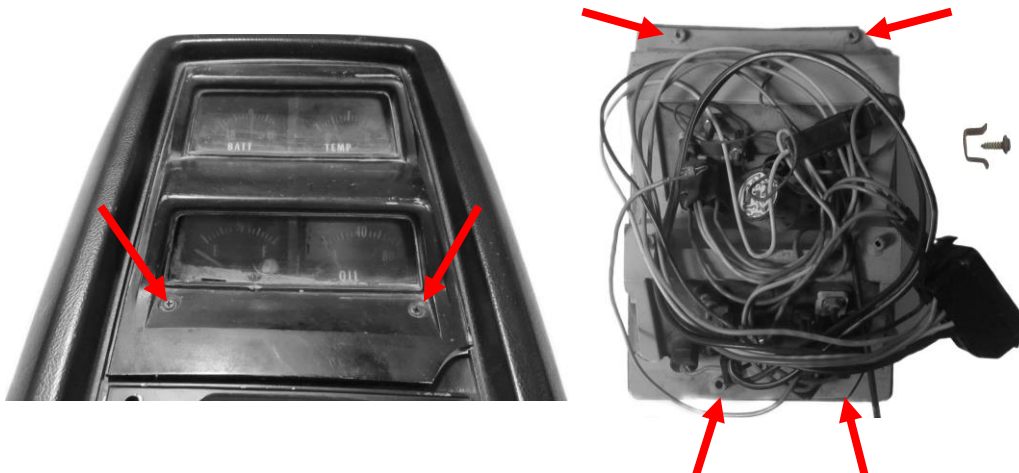

11a. Place the bezel over the HDX system and be sure to align the tabs from the bezel into the slots cut into the HDX housing as shown.



11b. Attach the bezel to the HDX cluster using the original screws from disassembly and the two (2) flat spring nuts provided.

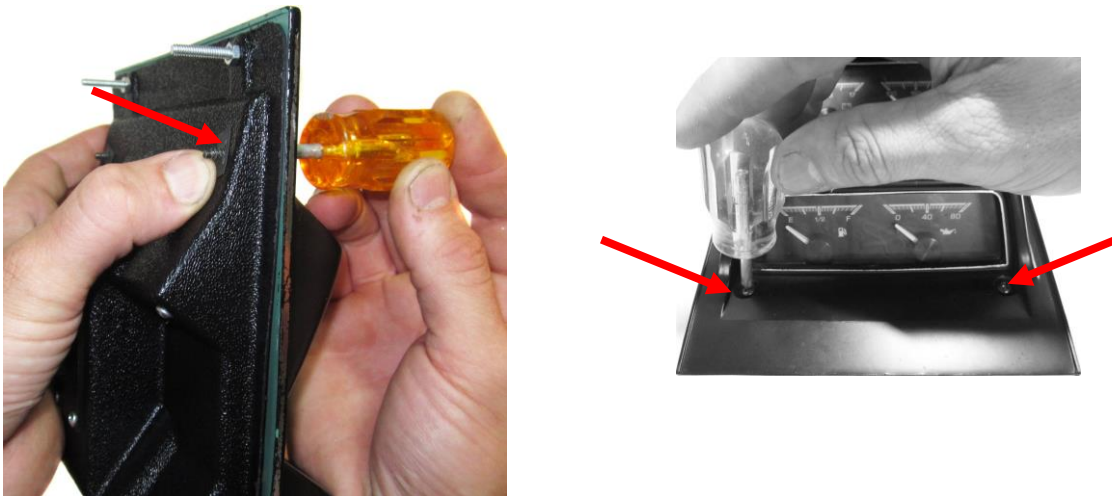

12. With the bezel mounted to the HDX system, align the cluster back into the console and use the provided four (4) fender washers and thumb nuts provided to secure the cluster to the console. Also connect the final main harness to the back of the HDX system. The console is now ready to reinstall back into the vehicle.

Route cable between the HDX system and bracket
NOT UNDER THE BRACKET

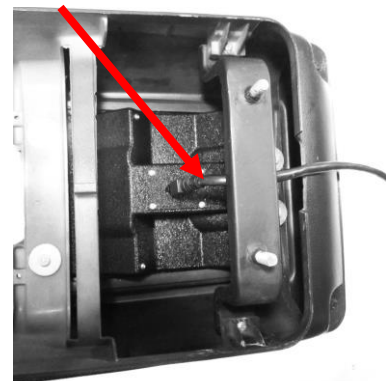
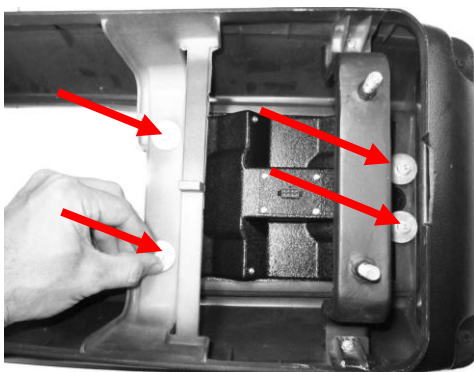

13. Connect the provided Y harness to the Control Box so both main harnesses can be connected.

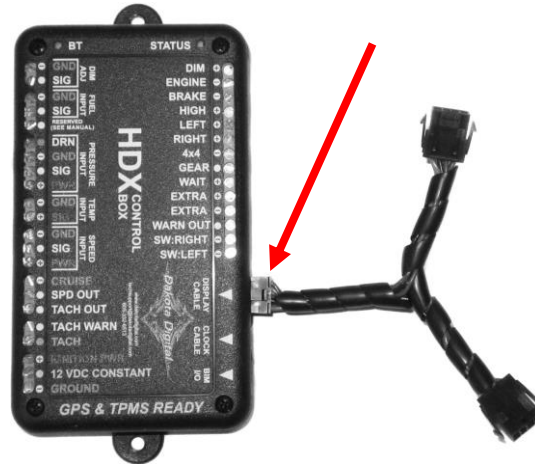

14. Carefully route both main harnesses to the control box mounting location and connect to the Y harness; refer to the main manual for wiring instructions to complete the HDX installation.



⚠ WARNING: This product can expose you to chemicals including lead, which is known to the State of California to cause cancer and birth defects or other reproductive harm. For more information go to www.P65Warnings.ca.gov



4510 W. 61st St. North
Sioux Falls, SD 57107
www.dakotadigital.com
dakotasupport@dakotadigital.com

Phone (605) 332-6513
Fax (605) 339-4106

Copyright 2011 - Dakota Digital, Inc.